

DEPARTMENT OF TRANSPORTATION STATE OF GEORGIA

RIGHT OF WAY OF PROPOSED S.R. 2/U.S. 76 BRIDGE REPLACEMENT OVER HIGHTOWER CREEK

FEDERAL AID PROJECT
BR000-0000-00(303)
TOWNS COUNTY

FEDERAL ROUTE # 76
STATE ROUTE # 2
P.I. NO. 0000303

CONVENTIONAL SIGNS

STATE OR COUNTY LINE	---
CITY LIMIT LINE	---
LAND LOT LINE	---
PROPERTY LINE	---
SURVEY OR BASE LINE	---
RIGHT OF WAY LINE	---
EXISTING	---
REQUIRED	---
LIMIT OF ACCESS	---
REQD R/W & LIMIT OF ACCESS	---
R/W MARKERS	---
FENCE	---
RAILROAD	---
POWER LINE	---
TELEPHONE LINE	---
POWER POLES	---
TELEPHONE OR TELEGRAPH POLES	---

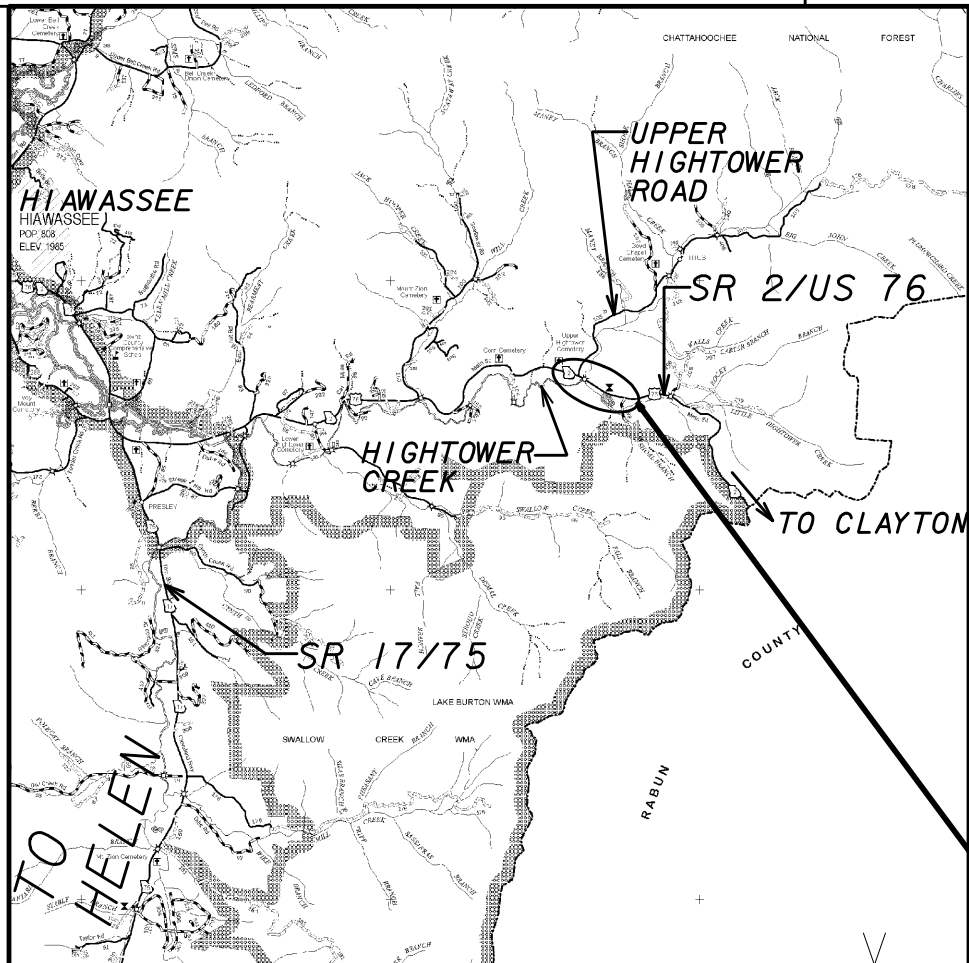

LOCATION SKETCH

PROJECT
BR000-0000-00(303)
TOWNS COUNTY

NOTE:
ALL WORK TO BE DONE IN ACCORDANCE WITH THE SPECIFICATIONS
OF THE DEPARTMENT OF TRANSPORTATION OF GEORGIA,
2001 EDITION, AS APPROVED BY THE FEDERAL HIGHWAY ADMINISTRATION.

ESA - SEE ENVIRONMENTAL RESOURCES
IMPACT TABLE IN GENERAL NOTES FOR
CONSTRUCTION RESTRICTIONS

FUNCTIONAL CLASS:
PRINCIPAL ARTERIAL

THIS PROJECT IS 100% IN
TOWNS COUNTY AND IS
100% IN CONG. DIST. NO. 9

PROJECT DESIGNATION: EXEMPT
PDP CLASSIFICATION: MINOR EXISTING

NOTE: THE CO-ORDINATES LISTED ARE WEST ZONE
GRID CO-ORDINATES BASED ON THE GA. STATE PLANE
CO-ORDINATE SYSTEM OF 1984.
HORIZONTAL DATUM: NAD 83/94 MARN
VERTICAL DATUM: NAVD 1988

STA 24+73.00
UPPER HIGHTOWER RD
LIMITS OF R/W ACQUISITION

STA 99+54.87 SR 2/US 76
BEGIN R/W ACQUISITION
N 1793935.0725
E 2451384.4403
M. P. 17.66

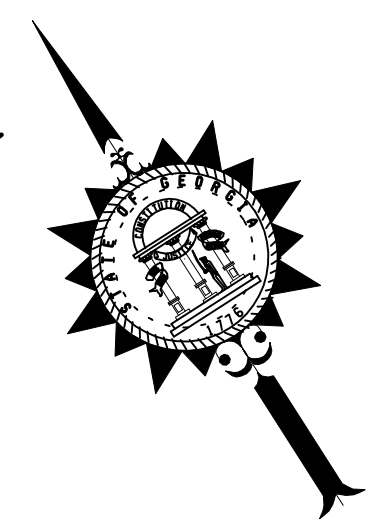
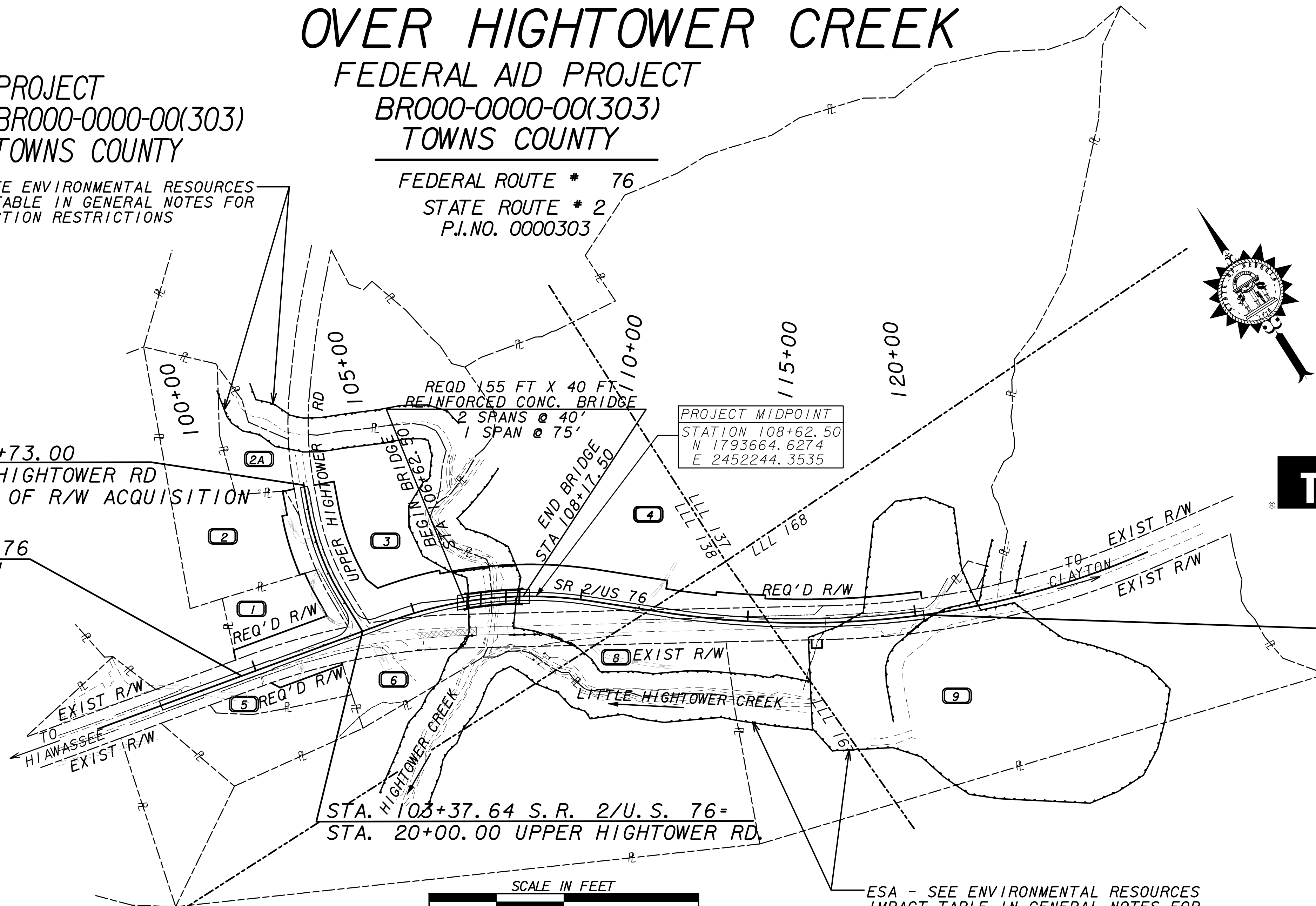

1780 Corporate Drive
Suite 400
Norcross, Georgia 30093
Tel 770.931.8005
Fax 770.931.8555
www.transystems.com

STA 120+25.00 SR 2/US 76
END R/W ACQUISITION
N 1792.994.5706
E 2453188.5726
M. P. 18.05

PREPARED BY: TRANSYSTEMS

UNDER THE
SUPERVISION OF: HIRAL P. PATEL
OFFICE OF PROGRAM DELIVERY

APPROVED: *Howard P. Copeland* **NOVEMBER 5, 2012**
HOWARD P. COPELAND
STATE RIGHT OF WAY ADMINISTRATOR DATE

LOCATION AND DESIGN APPROVAL DATE: 03-19-2001

PLANS COMPLETED DATE: 09-14-2012

REVISIONS:	
01-30-2013	SHEETS 1-5
07-25-2013	SHEETS 1-5
08-21-2013	SHEETS 1, 2, 5
09-16-2013	SHEETS 1, 2, 4

NOTE:
ALL REFERENCES IN THIS DOCUMENT, WHICH INCLUDES ALL PAPERS, WRITINGS, DOCUMENTS DRAWINGS, OF PHOTOGRAPHS USED,
OR TO BE USED IN CONNECTION WITH THIS DOCUMENT, TO 'STATE HIGHWAY DEPARTMENT OF GEORGIA', 'STATE HIGHWAY
DEPARTMENT', 'GEORGIA STATE HIGHWAY DEPARTMENT', 'HIGHWAY DEPARTMENT', OR 'DEPARTMENT' WHEN THE CONTEXT THEREOF
MEANS THE STATE HIGHWAY DEPARTMENT OF GEORGIA MEAN, AND SHALL BE DEEMED TO MEAN THE DEPARTMENT OF TRANSPORTATION.

THE DATA, TOGETHER WITH ALL OTHER INFORMATION SHOWN ON THESE PLANS OR IN ANYWAY INDICATED THEREBY, WHETHER BY
DRAWINGS OR NOTES, OR IN ANY OTHER MANNER, ARE BASED UPON FIELD INVESTIGATIONS AND ARE BELIEVED TO BE INDICATIVE
OF ACTUAL CONDITIONS. HOWEVER, THE SAME ARE SHOWN AS INFORMATION ONLY, ARE NOT GUARANTEED, AND DO NOT BIND THE
DEPARTMENT OF TRANSPORTATION IN ANY WAY. THE ATTENTION OF BIDDER IS SPECIFICALLY DIRECTED TO SUBSECTIONS 102.04,
102.05, AND 104.03 OF THE SPECIFICATIONS OF THE DEPARTMENT OF TRANSPORTATION, STATE OF GEORGIA, FOR THE CONSTRUCTION
OF ROADS AND BRIDGES, CURRENT EDITION, AND ANY MODIFICATIONS THEREOF, WHICH WILL BE PART OF THIS CONTRACT.

BR000-0000-00(303) TOWNS COUNTY

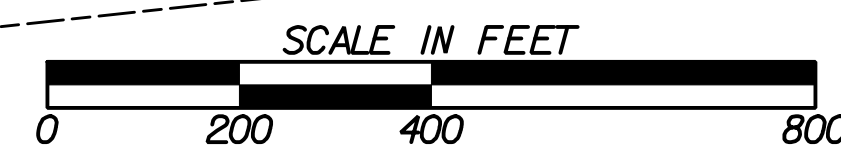

LENGTH OF RIGHT OF WAY PROJECT	TOWNS COUNTY NO. 281
	MILES
NET LENGTH OF RIGHT OF WAY	0.392
NET LENGTH OF BRIDGES	0.029
NET LENGTH OF EXCEPTIONS	0.000
GROSS LENGTH OF RIGHT OF WAY	0.392

G. M. D. 1138
18th LAND DISTRICT

ESA - SEE ENVIRONMENTAL RESOURCES
IMPACT TABLE IN GENERAL NOTES FOR
CONSTRUCTION RESTRICTIONS