

BEGIN PROJECT STP-0000-00(476)
 BEGIN CONSTRUCTION
 STA. 10+00.00
 N 1518462.5060
 E 2194711.7890 NORTH GEORGIA FOREST
 PRODUCTS, INC.

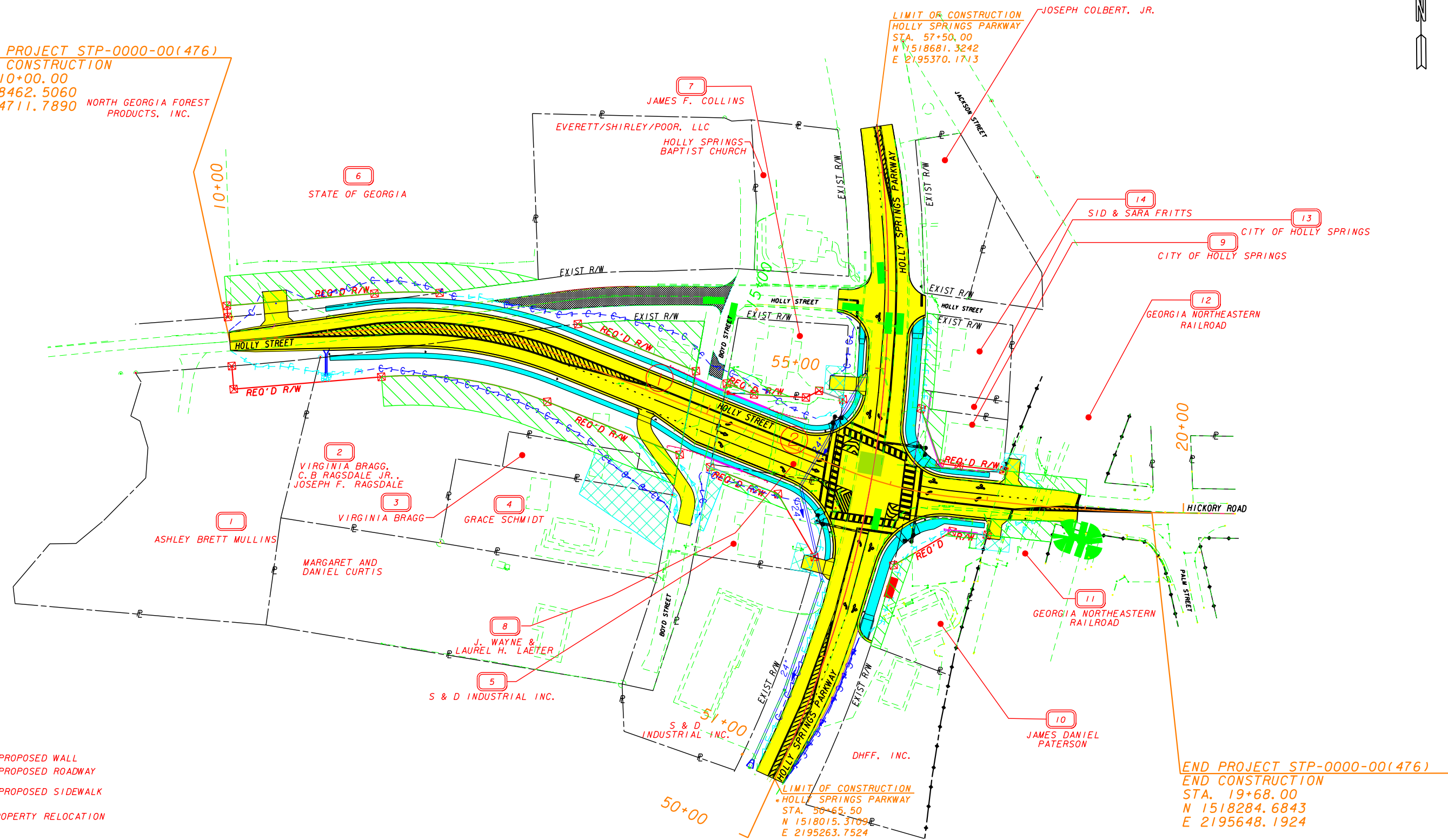

- PROPOSED WALL
- PROPOSED ROADWAY
- PROPOSED SIDEWALK
- # PROPERTY RELOCATION

END PROJECT STP-0000-00(476)
 END CONSTRUCTION
 STA. 19+68.00
 N 1518284.6843
 E 2195648.1924

PROPERTY AND EXISTING R/W LINE — P —
 REQUIRED R/W LINE ————
 CONSTRUCTION LIMITS — C — F —
 EASEMENT FOR CONSTR & MAINTENANCE OF SLOPES
 EASEMENT FOR CONSTR OF SLOPES
 EASEMENT FOR CONSTR OF DRIVES

BEGIN LIMIT OF ACCESS.....BLA
 END LIMIT OF ACCESS.....ELA
 LIMIT OF ACCESS ————
 REQ'D R/W & LIMIT OF ACCESS ————

SCALE IN FEET
 0 50 100 200

HORIZ. DATUM: NAD 83. VERT. DATUM: NAVD 29

HISTORIC BOUNDARY ————

HL Heath & Lineback Engineers
 INCORPORATED
 12 POWDER SPRINGS STREET, SUITE 240
 MARIETTA, GEORGIA 30064

LAND LOT NO: 344

| REVISION DATES | |
|----------------|--|
| | |
| | |
| | |
| | |

STATE OF GEORGIA
 DEPARTMENT OF TRANSPORTATION
 OFFICE: DISTRICT 6 DESIGN
MAINLINE CONSTRUCTION PLANS
 HOLLY STREET/HICKORY ROAD
 & HOLLY SPRINGS PARKWAY

DRAWING No.
13-1