

AUSTELL ROAD AT HOSPITAL DRIVE  
 MSL-0004-00(405)  
 COBB COUNTY  
 P. I. NO. 0004405

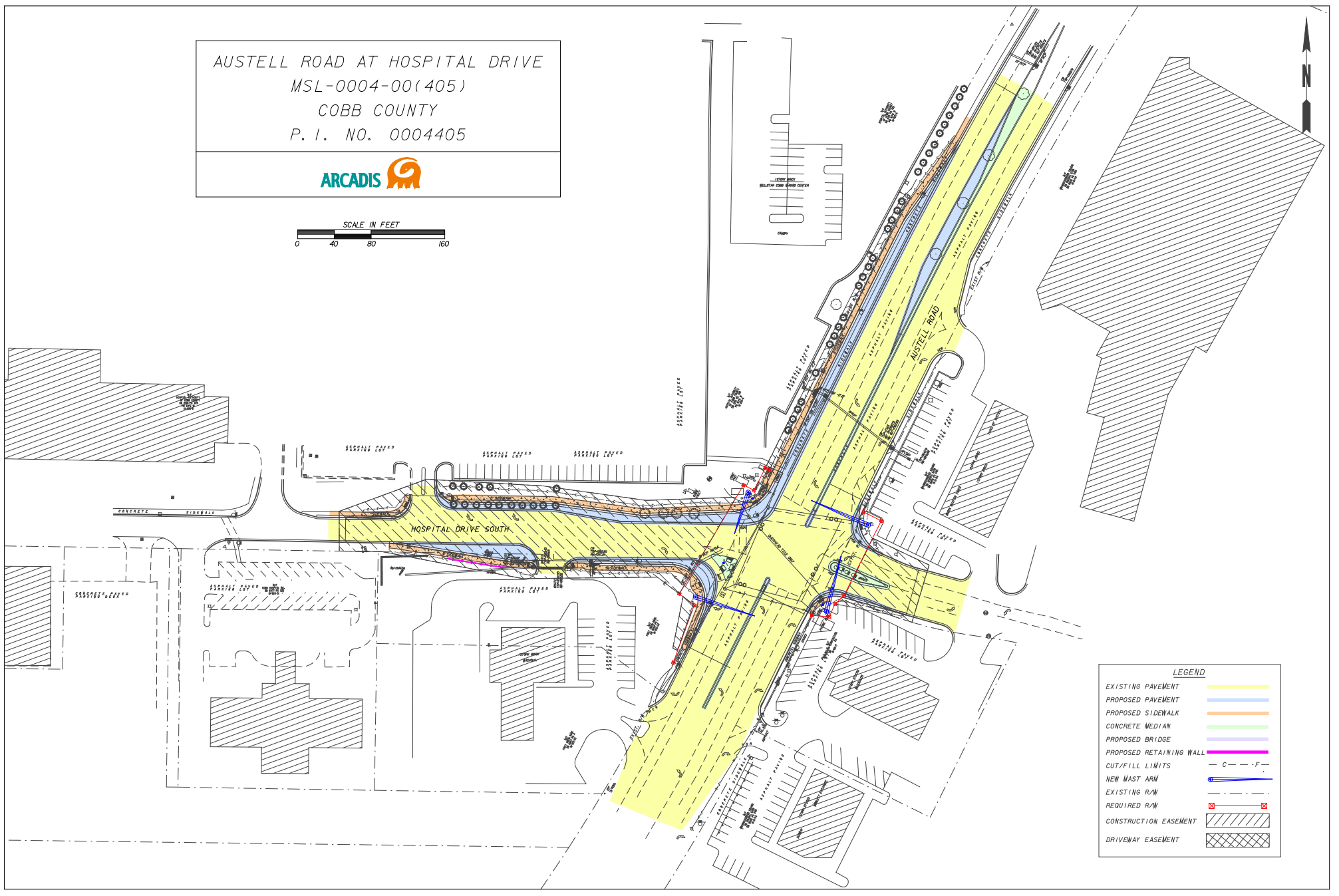
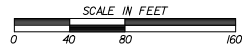

LEGEND	
EXISTING PAVEMENT	
PROPOSED PAVEMENT	
PROPOSED SIDEWALK	
CONCRETE MEDIAN	
PROPOSED BRIDGE	
PROPOSED RETAINING WALL	
CUT/FILL LIMITS	
NEW WAST ARM	
EXISTING R/W	
REQUIRED R/W	
CONSTRUCTION EASEMENT	
DRIVEWAY EASEMENT	